

Addendum No: 2
Date: January 12, 2024
Owner: Northern Health
Stantec # 144320228

This addendum is to be read with and constitutes part of the tender document.

0.0 **GENERAL**

Please note the following date changes:

Registration Deadline: 2024/02/02 at 2pm
Question Deadline: 2024/01/30 at 5pm
Closing Date/Time: 2024/02/02 at 2pm

Estimated Award Date: 2024/02/09

1.0 **SPECIFICATIONS**

Section 25 05 00 COMMON WORK FOR CONTROL SYSTEMS

Part 1.2.3.2 Scope of work

Delete: Delta Controls

Replace with: Reliable Controls

Part 1.2.4 Scope of work

Delete: Delta Controls enteliWEB system

Replace with: Reliable Controls RC Webview, RC Archive and IFDD

Part 1.4.1 General

Delete: enteliWEB

Replace with: RC Webview

Section 25 09 13 INSTRUMENTATION AND CONTROL DEVICES

Part 2.1.2.1 General

Delete: Delta Controls

Replace with: Reliable Controls

Part 2.2.1 Software

Delete: enteliWEB

Replace with: RC Webview and RC Archive

Part 2.3.5.9 Air Valve Controllers

Delete: Delete .9 in its entirety

Part 2.3.14.1 Air Valve Controllers

Delete: Delta Controls eZ-440

Replace with: Reliable Controls RC-FLEXair

Section 25 09 25 BUILDING AUTOMATION SYSTEM

Part 2.5 System software features

Delete: Delta Controls enteliWEB system

Replace with: Reliable Controls RC WEBview

Part 2.7 Operator Interface

Delete: Delta Controls enteliWEB system

Replace with: Reliable Controls RC WEBview

Section 25 90 10 CONTROL SEQUENCES OF OPERATIONS

Part 1.2.1.1 Controls contractor

Delete: Delta Controls

Replace with: Reliable Controls

Section 23 40 00 PLUMBING FIXTURES AND TRIM

Part 2 Products

Add:

COUNTER MOUNT HAND SINK SK-2:

- .1 **Sink:** Single compartment countertop mount medical hand wash sink – Franke HWS6810P-3. 18 gauge (1.2 mm), type 304 (CNS 18/10) stainless steel. Exposed surfaces are #4 satin finished. Sink compartment is angled. Undercoated to reduce condensation and resonance. Includes waste fitting, sound deadening pads, factory applied rim seal, cutout template, and factory installed EZ TORQUE™ fasteners. Certified to ASME A112.19.3-2008 / CSA B45.4-08. Right rear waste location. Includes 1 1/2" (38 mm) duplex waste assembly with rubber stopper and 1 1/2" (DN38) brass tailpiece. With Faucet ledge. Deck mounted faucet (see below).
- .2 Model Options: HWS6810P-3/3, 3 faucet holes 1 1/2" diameter, 4" centres, 8" centreset. 546 x 508 mm Overall. 406 x 457 x 254 mm Bowl. (FB x LR x D).
- .3 **Faucet: American Standard Monterrey #7500170.002 Two handles Faucet,** Polished Chrome finish, Brass, 1.9 LPM (0.5 GPM) pressure compensating aerator outlet, Rigid/limited swing gooseneck spout, 127 mm (5") projection reach, 4" (102 mm) long vandal resistant red and blue indexed wrist blade handles.
- .4 **Thermostatic Mixing Valve:** Franke MIX-LF, thermostatic mixing valve, Point Of Use Thermostatic Water Mixing Valve, nickel plated bronze body, temperature adjusting spindle, 10 mm (3/8") inlets and outlet FNPT connections, Integral checks, offer temperature range between 35 °C (95 °F) and 46 °C (114.8 °F), housed in 356 mm x 356 mm x 152 mm (14" x 14" x 6") recessed box. Set valve temperature at 46 °C (114.8 °F). Note : Provide tee, adaptors and flex. copper tubing to suit installation. Provide tempered water to hot side of faucet.

- .5 McGuire #LFH165LKN3RB Faucet Supplies (provide length(s) to suit), Chrome plated finish polished brass, heavy duty angle stops, 10 mm (3/8") I.P.S. Inlet x 76 mm (3") long rigid horizontal nipples, V.P. Loose keys, Escutcheon and stainless steel braided flexible risers.
- .6 McGuire #8912CBSAN P-Trap, SANIGUARD Antimicrobial Protection, heavy cast brass adjustable body, with slip nut, 38 mm (1-1/2") size, Box flange and Seamless tubular wall bend.
- .7 Provide escutcheons for all wall and floor penetrations. Provide commissioning services, thus ensuring operation as intended for the use. Coordinate and provide the required power for the faucet(s).

2.0 **DRAWINGS**

Architectural

1. AE104 – Comment updated refer to attached drawings.
2. AE-112 – Floor color changed to Tarket iQ Granit 161 Grey for all flooring.
3. AE201 – Comments updated refer to attached drawings.
4. AE202 - Comments updated refer to attached drawings.
5. GI-002 - Comments updated refer to attached drawings.

Mechanical:

1. M101 – Return all control devices part of demolition to FMO. Comment updated.
2. M102 – Equipment Label updated.
3. M104– Equipment Label updated.
4. M105 – Minimum curb height 203mm (8")
5. M106– Equipment Label updated.
6. M401– Equipment Label updated.
7. M402– Equipment Label updated.
8. M403- Equipment Label updated.
9. M500– Equipment Label updated.
10. M501- Equipment Label updated.

Electrical

.1 Lighting Revision (Refer to Luminaire Schedule in electrical drawing E301.)
As per UHNBC's request,

Type LR22 luminaire category number to be revised to 2SBP3040L8CS-2-UNV-DIM.
Manufacturer: Day Brite CFI by Signify. Substitution of vendor not permitted.

Type LR22F luminaire category number to be revised to 2SBP3040L8CS-2-UNV-DIM With recessed drywall mounting hardware "FMA22". Manufacturer: Day Brite CFI by Signify. Substitution of vendor not permitted.

.2 Mechanical Equipment Name Tag Revision (Refer to Mechanical Equipment Schedule in electrical drawing E301)
AHU-PH-01 TO RTU-3
EF-PH-01A to EF-WW-0-1A
EF-PH-01B to EF-WW-0-1B
SAV to SVAV-WW-010, SVAV-WW-011, SVAV-WW-012...
EAV to EVAV-WW-010, EVAV-WW-011, EVAV-WW-012...

Contractor to ensure the power to be provided for all EAVs and SAVs. Refer Mechanical Schedules on mechanical drawing M501 for total quantities.

3.0 CLARIFICATIONS

Question: Many of the subcontractors are having delayed times for pricing for the required specifications. We are requesting that the submittal time be extended by 1-week to allow for additional pricing time.

Answer: Please refer to General Section 0.0

Question: Please confirm where the closest Data closet is located to confirm our cable distances.

Answer: The closest data closet is located as per drawing below, and is situated on Level 0 as per plans below.

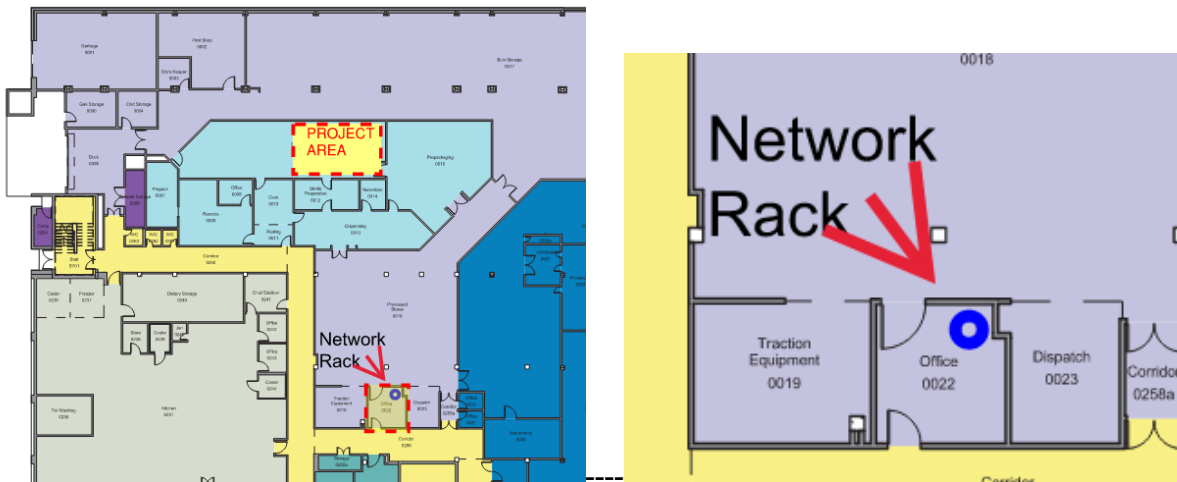

Question: Schedule: Approximately when would the stainless steel casework be required on site for installation?

Answer: It is up to the contractor to coordinate the work.

Question: Worktop Substrate: Section 12 31 00; Item 2.2.4.1 lists fibreboard and plywood for substrate for stainless steel worktops. Section 2.3 lists plywood core. Section 2.6.2 calls for s/s hat channel substrate. Dwg AE302 / UC2 notes no exposed wood. Please confirm requirements for worktop substrate. a. Is underside of worktops to be sheeted with stainless steel?

Answer: The core of the stainless-steel worktops can be all of the above noted in the specifications, but all sides and underside have to be fully covered by stainless steel so that it can be cleanable and meet NAPRA requirements and operational requirements.

Question: 12 31 00 Section 2.4.5 – Are locks required on any cabinets?

Answer: No, locks are not required on any cabinets.

Question: 12 31 00 Section 2.4.11 – please confirm that casters are not required on any cabinets

Answer: No, casters are not required on any cabinets.

Question: 5. 12 31 00 Section 2.6.5 – is marine edge required on any worktops?

Answer: No, marine edges are not required on any worktops

Question: Dwg AE202 – Please advise elevation keynote for item 710

Answer: Item 710 is a stainless-steel cabinet with fixed shelf.

Question: Please confirm it is acceptable to supply cabinets in standard sizes, instead of custom sizes shown on architectural drawings:

- a. Lower Cabinet: 762mm (30”) wide instead of 800mm wide
- b. Lower Cabinet: 610mm (24”) wide instead of 615mm wide
- c. Lower Cabinet: 457mm (18”) wide instead of 450mm wide

Answer: Yes, the proposed dimensions are acceptable

Question: Please confirm that the upper Cabinet shown on AE202/4 is acceptable to be 610mm (24”) wide x 610mm (24”) high x 14” deep

Answer: Yes, this is acceptable.

Question: Please confirm that lower cabinet depth of 22” is acceptable, with rear filler panels to the wall as required.

Answer: Yes, this is acceptable.

Question: Please confirm that a mechanical worktop seam is acceptable for “L” shaped worktop on Elev AE201/4. The worktop is too large to move into place in once piece.

Answer: L-shape counter can be made of two separate worktops and bases.

Question: Please confirm that coved flooring will be installed after cabinets are installed. a. Note: cabinet toe kicks are integral to the cabinet and cannot be installed prior to the cabinet body.

Answer: As noted on AE-302, yes, the fixed cabinets will require to be installed first and the cove based will need t be installed after.

Question: AE302 – Sink Detail – Please provide more information as to this drawing. Does this incorporate into the stainless-steel casework? If yes, how?

Answer: As noted on the drawing AE302, the sink is dropped in and should be sealed to the stainless-steel worktop.

Question: Duct Cleaning

- Section 23 05 00 Item 1.4.9 (on page 4 of 35) states to Clean and sanitize all supply and return ductwork.
- Section 23 05 00 item 1.43.2.3.2 (on page 17 of 35 asks for a Duct Cleaning Certificate for Project close out.

But there is no duct cleaning specification, please confirm if duct cleaning is actually required and if it is please provide a duct cleaning spec.

Answer: Duct cleaning is required and is to be completed by an approved cleaning agency listed in specification section 23 99 66. This agency will provide a Duct Cleaning Certificate when complete, which is to be submitted to consultant for review prior to project closeout.

The noted specification Section 23 05 00 Part 1.4.9. captures the requirements of the duct cleaning.

Question: Phasing is mentioned on the drawings/specs but is not clearly identified. Provide clarification on the requirements for phasing of this project.

1. how many phases?
2. Identify on the drawings the areas that are phased
3. number the phases.

Answer: The work will be completed in one phase for the main pharmacy, and the temporary space (0259a) will need to be functional before the commencement of the main space renovation and needs to be converted back after renovation.

Question: Please confirm if all exhaust is to be stainless steel welded

Answer: Yes, all exhaust ductwork is to be stainless steel with sealed seams as per specification Section 23 31 00 Part 2.8.1.

Question: AE112 Schedule refers to WP-1 and WP-2 is this in the reference to section 09 72 16, and what is the difference between?

Answer: There is no difference between WP-1 and WP-2 same product the only difference is the height installation, but we don't need to have different heights, so drawings have been updated to show only WP-1 at 4' above cove base.

Question: Section 07 52 00 (Part 2, Product 2.6 – 3 pg.4) MODIFIED BITUMEN MEMBRANE ROOFING – ROOFTOP GUARDRAIL SYSTEM - Request for Substitution/Equivalent - Delta prevention VSS COMPACT

Answer: Yes, the proposed compact guardrail system is acceptable.

Question: AE001 – Phasing and hoarding legend shows Hoarding Type 1 & Hoarding Type 2 with very similar line patterns. It appears that Hoarding Type 1 is not required on this project.

Answer: Refer to AE001 note 1. Phasing & Hoarding General notes.

Question: AE102 shows the roof curb detail, and AE105 shows the HSS Roof Penetration detail but does not show any insulation requirements inside the building. There is section 07 21 19 for Foamed in place insulation: please confirm the extent.

Answer: Add insulation around HSS

Question: Detail 2/AE102 has a note to refer to Mech for HSS post – this is not shown in the Mechanical. Structural shows a different detail (175mm x 150mm x 50mm spacer). Please confirm the correct detail to follow.

Answer: Please refer to structural detail for structural related scope.

Question: Section 07 52 00 identifies the roof assembly as SBS over a concrete slab. The drawings details do not show concrete in the roof assembly. Please confirm which is correct.

Answer: Roof on level 3 is a steel deck roof, refer to drawing L3 on sheet AE104.

Stantec Architecture Ltd.

Eleonore Leclerc
Principal, Architect AIBC, SAA, OAA

Cell: 604 369-6753
Eleonore.Leclerc@stantec.com

END OF ADDENDUM #2