

NOTE:
 PLATES TO BE CSA G40.21 GRADE 300W
 - REFER CT SHOP DRAWINGS / INSTALLATION MANUAL
 - PROVIDE THROUGH-ROD IN LIEU OF ANCHOR
 - ROD GRADE AS SPECIFIED IN CT DOCUMENTATION

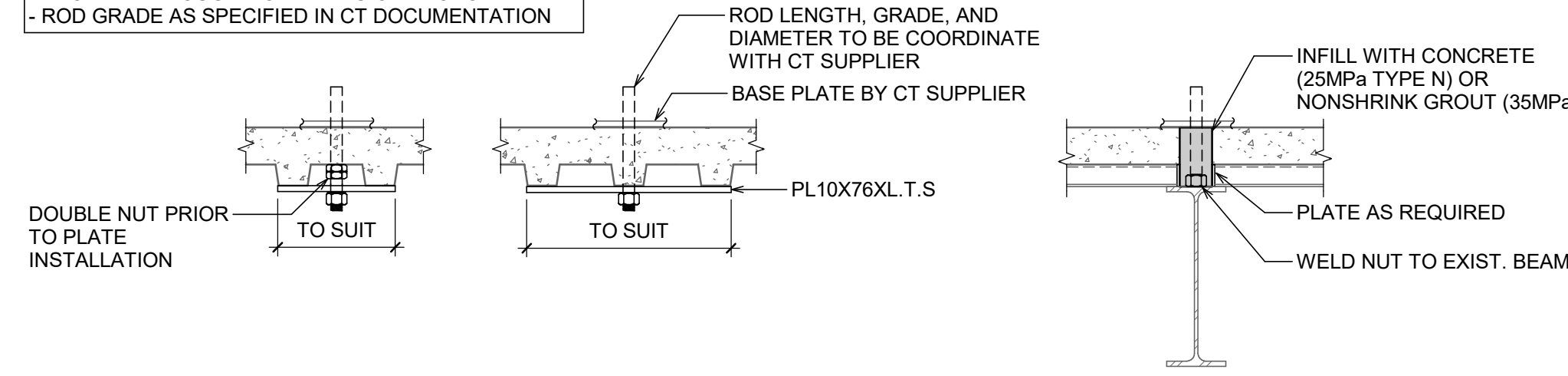

CASE 1: ROD @ HIGH FLUTE **CASE 2: ROD @ LOW FLUTE** **CASE 3: BEAM BELOW**

2
S-101 1:10

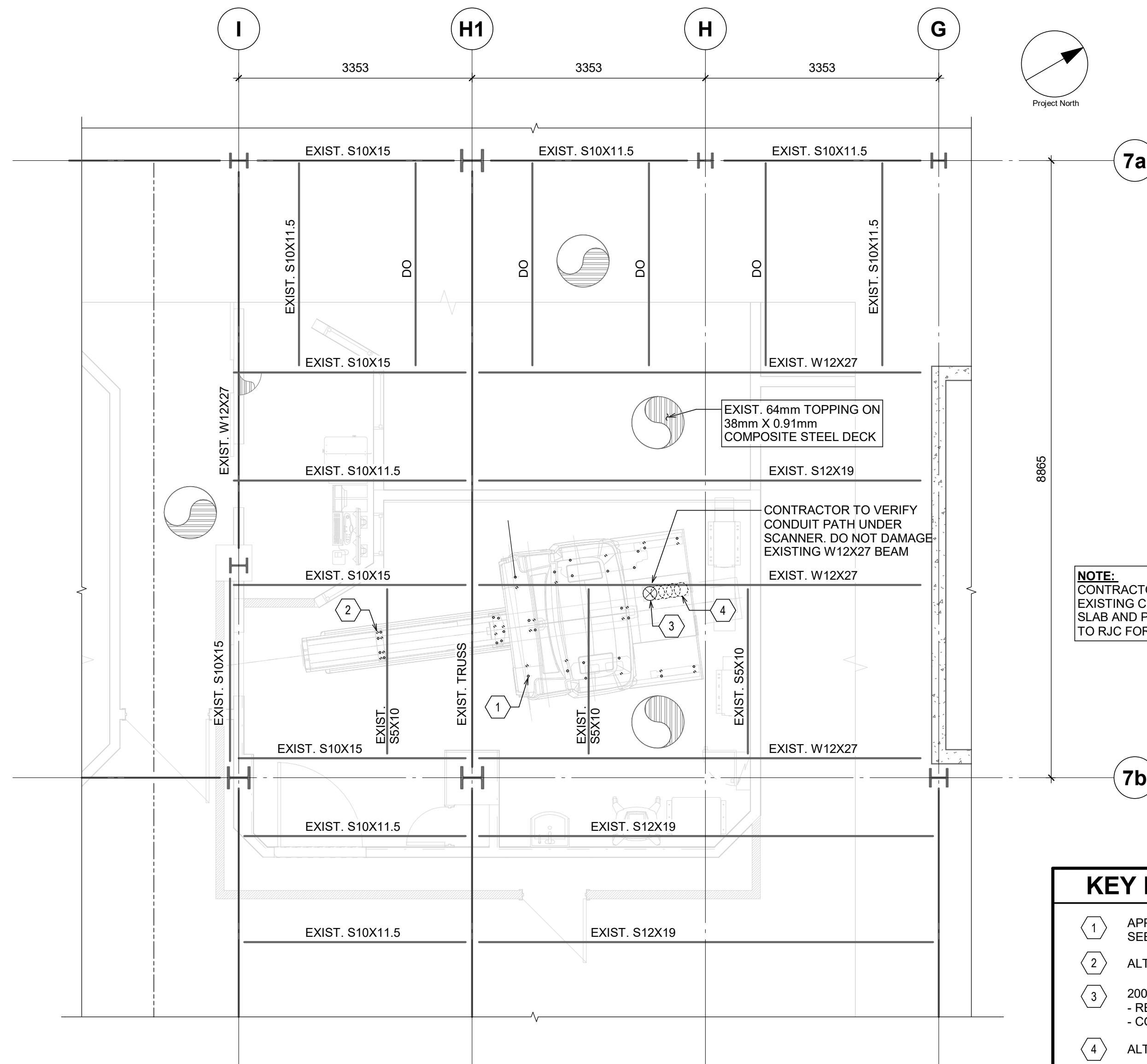

NOTE:
 CONTRACTOR TO LOCATE EXISTING CORES THROUGH SLAB AND PROVIDE LOCATIONS TO RJC FOR REVIEW

KEY NOTES

1	APPROX. LOCATIONS OF THROUGH-BOLTS, SEE DETAIL 2/S-101 FOR ANCHORAGE
2	ALTERNATE LOCATIONS OF THROUGH-BOLTS, SEE NOTE 1.
3	200Ø CORE - REFER CT SHOP DRAWINGS / INSTALLATION MANUAL - CONTRACTOR TO LOCATE SLAB REINF. FOR RJC REVIEW
4	ALTERNATE LOCATIONS FOR 200Ø CORE, SEE NOTE 3.

1
S-101 1:50
PARTIAL PLAN - FIRST FLOOR

SHOP DRAWINGS

- AS PART OF OUR CONSTRUCTION PHASE SERVICES, RJC WILL REVIEW SHOP DRAWINGS PERTAINING TO WORK SHOWN ON RJC'S DRAWINGS BY MEANS OF APPROPRIATE RATIONAL SAMPLING PROCEDURES AND COMMENT ON THE ACCURACY WITH WHICH THE CONTRACTOR PREPARED THE DRAWINGS.
- REVIEW OF SHOP DRAWINGS IS FOR THE SOLE PURPOSE OF ASCERTAINING CONFORMANCE WITH THE GENERAL DESIGN CONCEPT AND IS NOT AN APPROVAL OF THE DETAILED DESIGN INHERENT IN THE SHOP DRAWINGS, RESPONSIBILITY FOR WHICH SHALL REMAIN WITH THE CONTRACTOR SUBMITTING THEM. SUCH REVIEW SHALL NOT RELIEVE THE CONTRACTOR OF THEIR RESPONSIBILITY FOR ERRORS AND OMISSIONS IN THE SHOP DRAWINGS AND FOR MEETING ALL REQUIREMENTS OF THE CONTRACT DRAWINGS. THE CONTRACTOR IS SOLELY RESPONSIBLE FOR INFORMATION PERTAINING TO THE FABRICATION PROCESS, TECHNIQUES FOR CONSTRUCTION AND INSTALLATION, AND FOR CO-ORDINATION OF THE WORK OF ALL SUB-TRADES.
- FOR SPECIFIC SHOP DRAWING SUBMITTAL REQUIREMENTS, SEE APPROPRIATE MATERIAL SECTIONS AND THE SPECIFICATIONS.
- SHOP DRAWINGS SHALL BE COMPLETE AND INCLUDE ANY REQUIRED SEALS FROM A PROFESSIONAL ENGINEER REGISTERED IN THE JURISDICTION WHERE THE PROJECT IS LOCATED PRIOR TO SUBMISSION.
- ALL SHOP DRAWINGS COMPRISING A REVISED SUBMISSION SHALL INDICATE THE REVISED CONTENT BY MEANS OF CLOUDING OR OTHER SUITABLE MARKINGS.

RENOVATIONS

- THE CONTRACT DOCUMENTS ARE BASED ON ASSUMED AS-BUILT DIMENSIONS FOR THE EXISTING BUILDING STRUCTURE AND ASSUMPTIONS IN ACCORDANCE WITH DETAILING AND PLAGING PRACTICE. THESE ASSUMPTIONS MAY VARY FROM THE ACTUAL ON-SITE CONDITIONS. THE CONTRACTOR SHALL IMMEDIATELY INFORM THE CONSULTANT OF ANY ACTUAL VARIATIONS FROM THE ASSUMED CONDITIONS.
- MINOR MODIFICATIONS WILL BE REQUIRED TO THE WORK INDICATED ON THESE DRAWINGS TO REFLECT ACTUAL SITE CONDITIONS. THE CONTRACTOR WILL COOPERATE WITH THE CONSULTANT AND RJC IN THIS REGARD. MINOR MODIFICATIONS WILL BECOME THE RESPONSIBILITY OF THE CONTRACTOR AND WILL NOT RESULT IN A CHANGE IN THE CONTRACT PRICE.
- ENSURE THAT ALL NECESSARY JOB DIMENSIONS ARE TAKEN AND ALL TRADES ARE COORDINATED FOR THE PROPER EXECUTION OF THE WORK. THE CONTRACTOR SHALL ASSUME COMPLETE RESPONSIBILITY FOR THE ACCURACY AND COMPLETENESS OF SUCH DIMENSIONS, AND FOR COORDINATION.
- PRIOR TO FABRICATION OF ANY STRUCTURAL MEMBERS, THE CONTRACTOR SHALL COMPLETE THIS SITE REVIEW OF CRITICAL "TIE-IN" DIMENSIONS AND CONFIRM ALL DIMENSIONS TO ENSURE PROPER FIT OF NEW WORK TO EXISTING. REPORT ANY DISCREPANCIES TO RJC PRIOR TO STARTING WORK.
- COMMENCEMENT OF CONSTRUCTION OR ANY PART THEREOF CONSTITUTES ACCEPTANCE OF EXISTING CONDITIONS AND MEANS DIMENSIONS AND ELEVATIONS HAVE BEEN CONSIDERED, VERIFIED AND ARE ACCEPTABLE.
- ANY OPENINGS THAT ARE NOT SHOWN OR INDICATED ON THE STRUCTURAL DRAWINGS SHALL BE REPORTED TO RJC FOR REVIEW. THESE OPENINGS MAY NOT BE ALLOWED, MAY HAVE TO BE MOVED, OR MAY REQUIRE ADDITIONAL STRUCTURAL WORK AND DETAILING. DO NOT PROCEED WITH THESE OPENINGS WITHOUT WRITTEN PERMISSION FROM RJC.
- NEW OPENINGS TO BE CUT THROUGH EXISTING FLOOR SLAB OR WALLS SHALL BE CLEARLY MARKED OUT BY THE CONTRACTOR. THE CONTRACTOR SHALL NOTIFY RJC ONCE THE MARKING OUT HAS BEEN COMPLETED SO THAT RJC CAN REVIEW THE PROPOSED LOCATIONS OF ALL NEW OPENINGS. DO NOT PROCEED WITH CUTTING OF NEW OPENINGS WITHOUT THE APPROVAL OF RJC.
- UNLESS NOTED OTHERWISE ON THE DRAWINGS NEW STRAIGHT SIDED OPENINGS THROUGH EXISTING SLABS AND WALLS SHALL BE SAWCUT WITH NO OVERCUTS. USE CORED HOLES AT THE CORNERS. JACKHAMMERING SHALL NOT BE PERMITTED. REFER TO THE DETAILS AND PROCEDURES INDICATED ON THE STRUCTURAL DRAWINGS FOR THE NEW OPENINGS. ALTERNATES TO THE ABOVE PROCEDURES MUST BE REVIEWED BY RJC PRIOR TO THE START OF DEMOLITION OR CONSTRUCTION.
- DRILL AND SITE MEASURE BOLT HOLES IN EXISTING STRUCTURE PRIOR TO FABRICATING STEEL CONNECTION PLATES. BOLT HOLES MAY HAVE TO BE MOVED FROM WHAT IS SHOWN ON THE DRAWINGS TO AVOID CUTTING EXISTING REINFORCING OR TO AVOID OTHER SITE CONDITIONS. SITE MODIFICATION OF STEEL CONNECTION PLATES WILL NOT BE ACCEPTED WITHOUT THE PRIOR APPROVAL OF RJC.

LIST OF STRUCTURAL DRAWINGS

S-101 GENERAL NOTES, PARTIAL PLAN AND DETAILS

DRAWINGS

- THIS SET OF DRAWINGS SHOWS THE COMPLETED PROJECT. THE DRAWINGS DO NOT SHOW COMPONENTS THAT MAY BE NECESSARY FOR CONSTRUCTION SAFETY. THE GENERAL CONTRACTOR IS RESPONSIBLE FOR SAFETY IN AND ABOUT THE JOB SITE DURING CONSTRUCTION, AND THE DESIGN AND ERECTION OF ALL TEMPORARY STRUCTURES, FORMWORK, FALSE WORK, SHORING, ETC. REQUIRED TO COMPLETE THE WORK.
- THE USE OF THESE DRAWINGS IS LIMITED TO THAT IDENTIFIED IN THE REVISIONS COLUMN. DO NOT CONSTRUCT FROM THESE DRAWINGS UNLESS MARKED "ISSUED FOR CONSTRUCTION" IN THE REVISIONS COLUMN. BY READ JONES CHRISTOFFERSEN LTD. THE DRAWINGS SHALL NOT BE USED FOR PRICING, COSTING, OR TENDER UNLESS SO INDICATED IN THE REVISION COLUMN. PRICING OR COSTING DRAWINGS ARE NOT COMPLETE AND ANY PRICES BASED ON PRICING OR COSTING DRAWINGS MUST INCLUDE ALLOWANCES FOR THIS.
- THE INFORMATION ON THESE DRAWINGS SHALL NOT BE USED FOR ANY OTHER PROJECT OR WORKS. THE INFORMATION ON THESE DRAWINGS APPLIES SOLELY TO THIS PROJECT.
- GENERAL NOTES SHALL BE READ IN CONJUNCTION WITH THE TYPICAL DETAILS AND PROJECT SPECIFICATIONS.

GENERAL

- SECTION MARK SHOWN THUS MEANS SECTION #4 ON DRAWING S-3.
- THE GENERAL CONTRACTOR SHALL REVIEW ALL THE DRAWINGS AND CHECK DIMENSIONS BEFORE CONSTRUCTION. REPORT DISCREPANCIES BETWEEN STRUCTURAL AND OTHER DISCIPLINES DRAWINGS FOR CLARIFICATION.
- DEFINITIONS:**
 - RJC: READ JONES CHRISTOFFERSEN OR ITS REPRESENTATIVE.
 - GENERAL CONTRACTOR: FOR THE PURPOSES OF THESE DRAWINGS, THE USE OF THE TERM "CONTRACTOR" OR "GENERAL CONTRACTOR" SHALL REFER TO THE PRIME PERSON OR COMPANY RESPONSIBLE FOR CONSTRUCTION OF THE PROJECT AND THE COORDINATION OF TRADES AND SUBCONTRACTORS. THIS MAY BE THE GENERAL CONTRACTOR, OR A CONSTRUCTION MANAGER.

DESIGN CODE

- THE COMPLETED COMPONENTS SHOWN ON THE STRUCTURAL DRAWINGS HAVE BEEN DESIGNED IN SUBSTANTIAL ACCORDANCE WITH THE BRITISH COLUMBIA BUILDING CODE 2024, EXCEPT THE DESIGN FOR EARTHQUAKE LOADS AND EFFECTS IS IN SUBSTANTIAL ACCORDANCE WITH ARTICLE 4.1.8 OF THE BRITISH COLUMBIA BUILDING CODE 2018.

DESIGN LOADS

SPECIFIED UNIFORM LOADS	LIVE LOAD	SUPERIMPOSED DEAD LOAD (S.D.L.)
A. FIRST FLOOR*	4.8	NOT SPECIFIED

* AS NOTED IN DRAWING S-4 BY MCKENZIE SNOWBALL SKALBANIA & ASSOCIATES LTD. CONSULTING ENGINEERS (1971)

SEISMIC:
 THE LATERAL RESTRAINT OF BUILDING COMPONENTS FOR THIS PROJECT IS DESIGNED FOR THE FOLLOWING EARTHQUAKE FACTORS:
 Sa (0.2) = 0.786 SITE CLASSIFICATION: SITE CLASS C
 Fa = 1.0 Ie = 1.5

AND THE FOLLOWING ELEMENT OR COMPONENT FACTORS:
 CATEGORY 11B - EQUIPMENT FLEXIBLY CONNECTED

Ar = 2.50
 Cp = 1.00
 Rp = 2.50

FIELD REVIEW BY READ JONES CHRISTOFFERSEN (RJC)

- READ JONES CHRISTOFFERSEN PROVIDES FIELD REVIEW ONLY FOR THE WORK SHOWN ON THESE STRUCTURAL DRAWINGS. THIS REVIEW IS NOT A "FULL TIME" REVIEW BUT IS CONDUCTED WITH SUCH FREQUENCY AS RJC DEEMS APPROPRIATE TO OBSERVE VARIOUS STAGES OF THE WORK AND TO ASCERTAIN THAT THE WORK IS IN GENERAL CONFORMANCE WITH THE PLANS AND SUPPORTING DOCUMENTS PREPARED BY READ JONES CHRISTOFFERSEN. FIELD REVIEW BY READ JONES CHRISTOFFERSEN IS NOT CARRIED OUT FOR THE CONTRACTOR'S BENEFIT, NOR DOES IT MAKE READ JONES CHRISTOFFERSEN GUARANTORS OF THE CONTRACTOR'S WORK. IT REMAINS THE CONTRACTOR'S RESPONSIBILITY TO BUILD THE WORK IN CONFORMANCE WITH THE CONTRACT DOCUMENTS. RJC SHALL NOT BE RESPONSIBLE FOR THE ACTS OR OMISSIONS OF THE CONTRACTOR, SUB-CONTRACTOR, OR ANY OTHER PERSONS PERFORMING ANY OF THE WORK OR FOR THE FAILURE OF ANY OF THEM TO CARRY OUT THE WORK IN ACCORDANCE WITH THE CONTRACT DOCUMENTS.
- PROVIDE 72 HOURS ADVANCE NOTICE OF EACH REQUIRED FIELD REVIEW. FIELD REVIEWS SHALL BE SCHEDULED TO BE CARRIED OUT DURING NORMAL BUSINESS HOURS UNLESS SPECIAL ARRANGEMENTS ARE MADE WITH RJC.
- THE WORK TO BE REVIEWED SHALL BE GENERALLY COMPLETE.

Read Jones Christoffersen Ltd.
 Engineers
 rjc.ca
 1285 West Broadway, Suite 300
 Vancouver, BC V6H 3X8 Canada
 tel 604-738-0048

ISSUED FOR CONSTRUCTION	2024.10.18
4 ISSUED FOR BP	2024.09.25
3 ISSUED FOR TENDER	2024.09.05
2 ISSUED FOR 90% CD	2024.08.21
1 ISSUED FOR 60% CD	2024.08.02

drawing notes

- All drawings, plans, models, designs, specifications and other documents prepared by Read Jones Christoffersen Ltd. ("RJC") and used in connection with this project are instruments of service for the work shown in them (the "Work") and as such are and remain the property of RJC whether the Work is executed or not, and RJC reserves the copyright in them and in the Work executed from them, and they shall not be used for any other work or project.
- These drawings are "design drawings" only. They may not be suitable for use as shop drawings. Use of these drawings as base drawings for "shop drawings" is not permitted unless written permission containing certain conditions and limitations is obtained from RJC. The work "as constructed" may vary from what is shown on these drawings.
- Use of these drawings is limited to that identified in the Issued/Revision column. Do not construct from these drawings unless marked "Issued for Construction" by RJC in the Issued/Revision column, and then only for the parts noted. The drawings shall not be used for "pricing" / "costing" or "tender" unless so indicated in the Issued/Revision column. "Pricing" or "Costing" drawings are not complete and any prices based on such drawings must allow for this.

client

NUCLEAR MEDICAL SCAN ROOM RENOVATION
 NHA UHNBC
 1475 EDMONTON STREET
 PRINCE GEORGE, BC V2M 1S2

EGBC Permit to Practice No.1002503

project no. **VAN.128760.0002**

drawing title
GENERAL NOTES, PARTIAL PLAN AND DETAILS

date	AUG 2024	sheet number	
scale	As indicated		S-101
drawn by	LJU	checked by	JWH
rev no.			5