

GENERAL SYMBOLS	
	NOTE REFERENCE
	EQUIPMENT REFERENCE
	REVISION NUMBER
	WIRING HOME RUN

SECURITY/ACCESS CONTROL SYMBOLS	
	CEILING MOUNTED SECURITY CAMERA
	AUTOMATIC DOOR OPERATOR
	CARD READER
	DOOR CONTACT SWITCH
	ELECTRIC STRIKE
	ELECTROMAGNETIC LOCK
	PUSHBUTTON
	REQUEST-TO-EXIT MOTION SENSOR
	REQUEST-TO-EXIT PUSHBUTTON

TELECOMMUNICATIONS SYMBOLS	
	WALL MOUNTED TELECOM OUTLET (# DENOTES NUMBER OF CABLES)
	FLOOR MOUNTED TELECOM OUTLET (# DENOTES NUMBER OF CABLES)
	CEILING MOUNTED TELECOM OUTLET (# DENOTES NUMBER OF CABLES)
	WIRELESS ACCESS POINT
	ANTENNA
	ANALOG CLOCK
	CEILING MOUNTED PA SPEAKER

ABBREVIATIONS	
EX	EXISTING DEVICE TO REMAIN
RE	REMOVE EXISTING DEVICE
RP	REPLACE EXISTING DEVICE WITH NEW DEVICE
RL	RELOCATE EXISTING DEVICE
AFF	ABOVE FINISHED FLOOR
AV	AUDIO-VISUAL
BMS	BUILDING MANAGEMENT SYSTEM
FEC	FIRE EXTINGUISHER CABINET
FR	FREEZER
GFCI	GROUND FAULT CIRCUIT INTERRUPTER
HK	HOUSEKEEPING
HT	HEAT TRACE WITH ASSOCIATED CONTROL PANEL
JB	JUNCTION BOX
MW	MICROWAVE
PA	PUBLIC ANNOUNCEMENT
PC	PERSONAL COMPUTER
PL	x
PTR	PRINTER
TYP	TYPICAL
UC	UNDERCOUNTER
WAP	WIRELESS ACCESS POINT
WP	WEATHERPROOF
WRK	STAFF WORK STATION

FIRE ALARM SYMBOLS	
	FIRE ALARM MANUAL STATION
	FIRE ALARM BELL
	FIRE ALARM CONE SPEAKER
	FIRE ALARM CONE SPEAKER w/ STROBE
	FIRE ALARM SMOKE DETECTOR
	FIRE ALARM SMOKE DETECTOR, DUCT MOUNTED
	SMOKE ALARM
	FIRE ALARM ANNUNCIATOR PANEL
	FIRE ALARM CONTROL PANEL
	CENTRAL ALARM & CONTROL FACILITY
	FIRE ALARM EMERGENCY TELEPHONE
	FIRE ALARM MAGNETIC DOOR HOLD OPEN DEVICE
	FIRE ALARM RELAY
	FIRE ALARM END OF LINE RESISTOR
	FIRE ALARM FAULT ISOLATION MODULE
	FIRE ALARM CONTROL MODULE
	FIRE ALARM MONITOR MODULE
	FIRE ALARM CONNECTION TO PRESSURE SWITCH
	FIRE ALARM CONNECTION TO FLOW SWITCH
	FIRE ALARM CONNECTION TO TAMPER SWITCH
	FIRE ALARM CONNECTION TO LEVEL SWITCH
	FIRE SMOKE DAMPER

POWER PLAN SYMBOLS	
	DUPLEX 5-15R RECEPTACLE
	DUPLEX 5-20R RECEPTACLE, T-SLOT
	TWO DUPLEX 5-15R RECEPTACLES
	DUPLEX 5-15R RECEPTACLE - CONNECTED TO EMERGENCY POWER
	TWO DUPLEX 5-15R RECEPTACLES - CONNECTED TO EMERGENCY POWER
	SPECIAL RECEPTACLE (TYPE AS INDICATED)
	CEILING MOUNTED JUNCTION BOX
	WALL MOUNTED JUNCTION BOX
	FLOOR MOUNTED JUNCTION BOX
	POWER PANELBOARD
	PANEL (TYPE AS INDICATED - SECURITY, LIGHTING RELAY, ETC.)
	GROUND BUS BAR
	ROOM REFERENCE GROUND BUS
	ROOM REFERENCE GROUND JUNCTION BOX
	MOTOR
	MOTOR w/ DISCONNECT SWITCH
	THERMOSTAT
	DEVICE MOUNTED ABOVE MILLWORK COUNTERTOP
	DIRECT CONNECTION

NURSE CALL SYMBOLS	
	WALL MOUNTED NURSE CALL DOME LIGHT
	CEILING MOUNTED NURSE CALL DOME LIGHT
	NURSE CALL SINGLE PATIENT STATION
	NURSE CALL DOUBLE PATIENT STATION
	NURSE CALL STAFF STATION
	NURSE CALL STAFF EMERGENCY STATION
	NURSE CALL STAFF DUTY STATION/TONE STATION, WALL MOUNTED
	NURSE CALL TONE STATION, CEILING MOUNTED
	WALL MOUNTED NURSE CALL EMERGENCY STATION w/ PULLCORD
	WALL MOUNTED NURSE CALL EMERGENCY STATION w/ PULLCORD, AUDIO
	WALL MOUNT BLUE STROBE
	NURSE CALL BUTTON STATION (CODES AS NOTED) - TYPICALLY CODE WHITE/CODE BLUE/CANCEL BUTTON
	NURSE CALL MASTER STATION
	NURSE CALL TERMINAL
	NURSE CALL MARQUEE

LIGHTING PLAN SYMBOLS	
	RECESSED LED LUMINAIRE, 1x4'
	RECESSED LED LUMINAIRE, 2x4'
	RECESSED LED LUMINAIRE, 2x2'
	LED STRIP LUMINAIRE, 4', EXACT LENGTH TO BE MEASURED ON SITE
	WALL MOUNTED LINEAR LUMINAIRE
	RECESSED LUMINAIRE / POT LIGHT, 6" DIAMETER OR LARGER
	RECESSED LUMINAIRE / POT LIGHT, LESS THAN 6" DIAMETER
	STEP OR WALL MOUNTED LUMINAIRE
	LUMINAIRE ON EMERGENCY CIRCUIT (INDICATED BY HALF SHADING)
	CEILING MOUNTED EXIT SIGN (TEXT ON SHADED SIDES, ARROWS AS INDICATED)
	WALL MOUNTED EXIT SIGN (TEXT ON SHADED SIDES, ARROWS AS INDICATED)
	LINE VOLTAGE SWITCH (120V TO 347V)
	LOW VOLTAGE DIMMER SWITCH
	LINE VOLTAGE DIMMER SWITCH
	LOW VOLTAGE SWITCH w/ OCCUPANCY SENSOR
	LINE VOLTAGE SWITCH w/ OCCUPANCY SENSOR
	CEILING MOUNTED LIGHTING OCCUPANCY SENSOR (TYPE AS INDICATED)
	WALL MOUNTED LIGHTING OCCUPANCY SENSOR (TYPE AS INDICATED)
	PHOTOCELL (EXTERIOR, TYPE AS INDICATED)
	DAYLIGHT SENSOR (INTERIOR PHOTOCELL, TYPE AS INDICATED)
	EMERG. LTG. BATTERY PACK (# OF LAMPS AS SHOWN)
	CEILING MOUNTED EMERG. LTG. REMOTE HEAD (# OF LAMPS AS SHOWN)
	WALL MOUNTED EMERG. LTG. REMOTE HEAD (# OF LAMPS AS SHOWN)
	COMBINATION EXIT SIGN/EMERG. LTG. BATTERY PACK

LIGHTING ANNOTATION LEGEND	
	LUMINAIRE TYPE (SCHEDULE REFERENCE)
	PANEL
	CIRCUIT
	SWITCH LEG

SCHEMATIC SYMBOLS	
	LOW VOLTAGE CIRCUIT BREAKER
	TRANSFORMER
	DELTA CONNECTION
	WYE CONNECTION
	GROUND CONNECTION
	PANELBOARD
	BREAK LINE
	CONTINUATION BREAK

ELECTRICAL DRAWING LIST	
E001	COVER PAGE
E100	LEVEL 1 - PATIENT CARE AREA CLASSIFICATION PLAN
E200	LEVEL 1 - POWER & COMMUNICATIONS DEMO - EAST SIDE
E201	LEVEL 1 - POWER & COMMUNICATIONS DEMO - WEST SIDE
E202	LEVEL 1 - POWER & COMMUNICATIONS DEMO - NORTH SIDE
E210	LEVEL 1 - FIRE ALARM, ACCESS CONTROL & NURSE CALL SYSTEM DEMO - EAST SIDE
E211	LEVEL 1 - FIRE ALARM, ACCESS CONTROL & NURSE CALL SYSTEM DEMO - WEST SIDE
E212	LEVEL 1 - FIRE ALARM, ACCESS CONTROL & NURSE CALL SYSTEM DEMO - NORTH SIDE
E220	LEVEL 1 - LIGHTING DEMO - EAST SIDE
E221	LEVEL 1 - LIGHTING DEMO - WEST SIDE
E222	LEVEL 1 - LIGHTING DEMO - NORTH SIDE
E300	LEVEL 1 - POWER & COMMUNICATIONS NEW - EAST SIDE
E301	LEVEL 1 - POWER & COMMUNICATIONS NEW - WEST SIDE
E302	LEVEL 1 - POWER & COMMUNICATIONS NEW - NORTH SIDE
E310	LEVEL 1 - FIRE ALARM, ACCESS CONTROL & NURSE CALL SYSTEM NEW - EAST SIDE
E311	LEVEL 1 - FIRE ALARM, ACCESS CONTROL & NURSE CALL SYSTEM NEW - WEST SIDE
E312	LEVEL 1 - FIRE ALARM, ACCESS CONTROL & NURSE CALL SYSTEM NEW - NORTH SIDE
E320	LEVEL 1 - LIGHTING NEW - EAST SIDE
E321	LEVEL 1 - LIGHTING NEW - WEST SIDE
E322	LEVEL 1 - LIGHTING NEW - NORTH SIDE
E400	ELECTRICAL SCHEDULES & DIAGRAMS (1 OF 2)
E401	ELECTRICAL SCHEDULES & DIAGRAMS (2 OF 2)
E405	ELECTRICAL PANEL SCHEDULES
Grand total: 23	

- GENERAL NOTES**
- OBTAIN ACCURATE DIMENSIONS FROM THE ARCHITECTURAL AND STRUCTURAL DRAWINGS.
 - PROVIDE FIELD MEASUREMENTS, WHERE EQUIPMENT AND MATERIAL DIMENSIONS ARE DEPENDENT UPON BUILDING DIMENSIONS.
 - PROVIDE A DETAILED REVIEW OF THE ARCHITECTURAL DRAWINGS TO COORDINATE INSTALLATION OF FEEDERS AND DEVICE FEEDS INTO THE BUILDING STRUCTURE.
 - WORK SHALL BE IN ACCORDANCE WITH THE DRAWINGS AND THEIR INTENT. WORK SHALL INCLUDE THE PROVISION FOR ALL MATERIALS, LABOUR, TOOLS, EQUIPMENT AND SERVICES REQUIRED FOR CONSTRUCTING, INSTALLING AND PUTTING INTO REGULAR OPERATION THE COMPLETE ELECTRICAL SYSTEM AS SHOWN ON THE DRAWINGS AND AS SPECIFIED IN CONTRACT DOCUMENTS.
 - CONTRACTOR SHALL REFER TO ARCHITECTURAL DRAWINGS FOR LOCATIONS OF ALL EXPOSED TO VIEW DEVICES, LIGHTING AND EQUIPMENT. EXAMINE AND BRING DISCREPANCIES TO THE ATTENTION OF THE ARCHITECT BY WRITTEN NOTICE FOR CLARIFICATION.
 - NOT ALL SYMBOLS INDICATED IN THE SYMBOL SCHEDULES ARE USED IN THE DRAWINGS.
 - REFER TO ARCHITECTURAL DRAWINGS FOR EXISTING AND NEW FIRE SEPARATIONS.
 - GREYED OUT SYMBOLS DENOTE EXISTING EQUIPMENT TO REMAIN.
 - DARK WITH DASHED LINES SYMBOLS DENOTE EQUIPMENT TO BE REMOVED OR RELOCATED.
 - DARK SOLID LINE SYMBOLS DENOTE NEW OR RELOCATED EQUIPMENT.

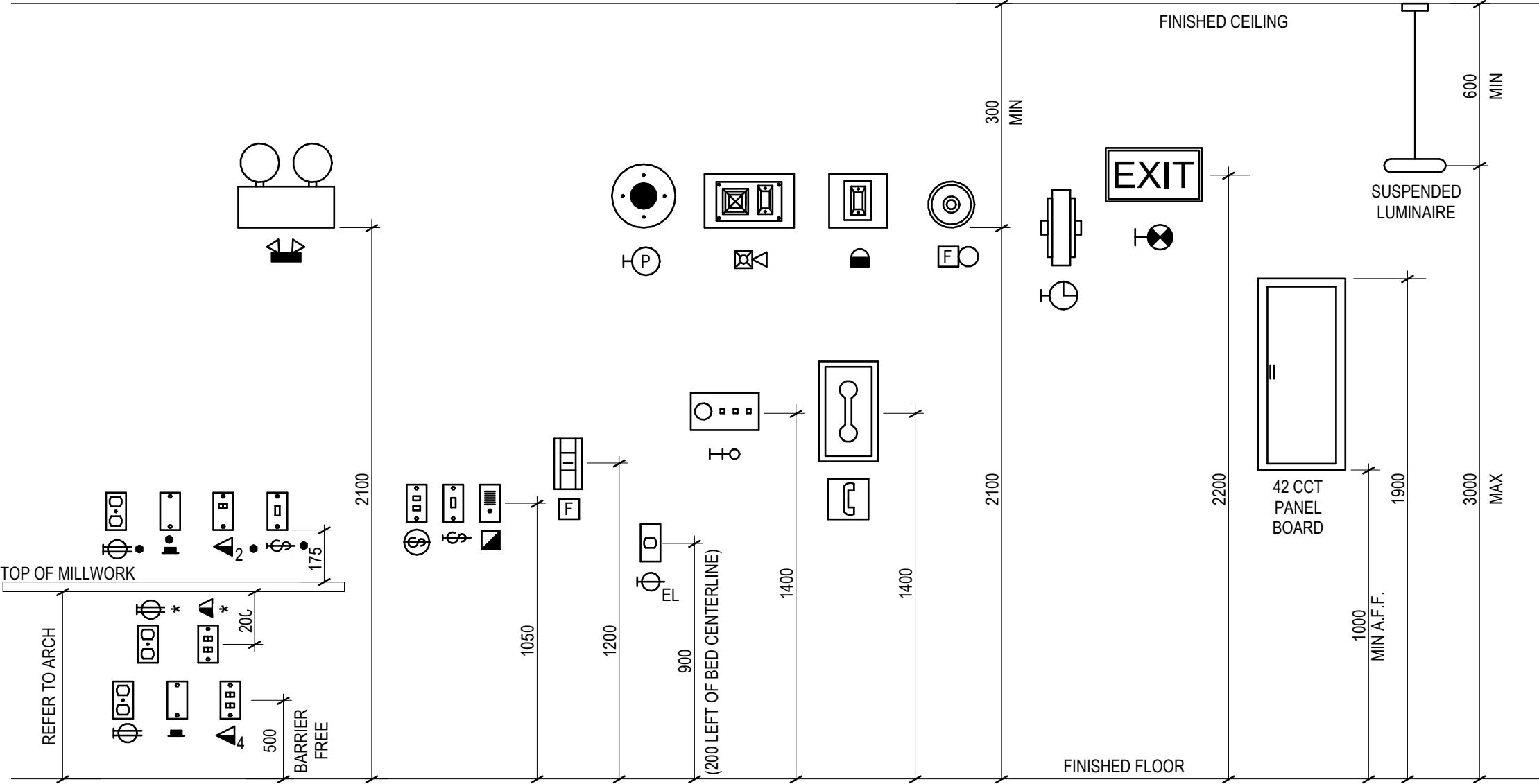



Project No. 144320012	Scale As indicated
Revision 2	Drawing No. E100

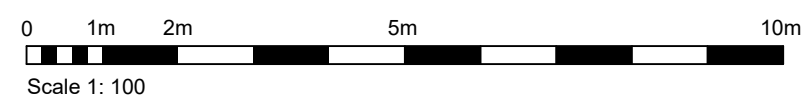



The Contractor shall verify and be responsible for all dimensions. DO NOT scale the drawing - any errors or omissions shall be reported to Stantec without delay. The Copyrights to all designs and drawings are the property of Stantec. Reproduction or use for any purpose other than that authorized by Stantec is forbidden.

Notes

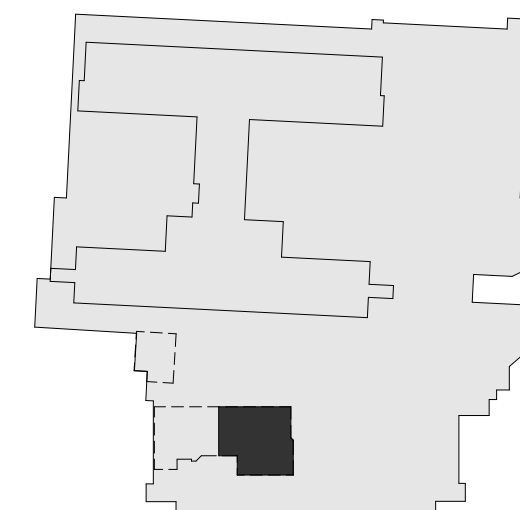
[illegible]

File Name: N/A	_____	_____	_____	_____
	Down.	Dsgn.	Chkd.	YYYY.MM

A circular professional seal for a Professional Engineer in the Province of British Columbia. The seal features the text "PROFESSIONAL ENGINEER" around the top and "PROVINCE OF BRITISH COLUMBIA" around the bottom. In the center, the name "J. F. FOURIE" and the number "31776" are printed. The seal is crossed out with a large, bold, handwritten "X".

2025-01-27
Stantec Permit#: 100280



northern health
the northern way of caring

Title
LEVEL 1 - POWER &
COMMUNICATIONS DEMO - EAST
SIDE

Revision	Drawing No.
2	E200

1. REFER TO GENERAL NOTES ON DRAWING E001

2. FOR ALL AREAS IN IDENTIFIED DEMOLITION AREA AND UNLESS OTHERWISE NOTED, CONTRACTOR SHALL REMOVE ALL ELECTRICAL DEVICES/EQUIPMENT BACK TO SOURCE, INCLUDING BUT NOT LIMITED TO DATA/PAPER CABLING, JUNCTION BOXES, OUTLETS AND ALL ASSOCIATED ELECTRICAL DEVICES, MECHANICAL EQUIPMENT AND CONTROL DEVICES.
3. CONTRACTOR SHALL PROVIDE THE NECESSARY JUNCTION BOXES, WIRING SPLICES AND COVER PLATES WHERE IT IS REQUIRED TO REMOVE ELECTRICAL DEVICES, EQUIPMENT, OR WIRING DEVICES, BUT THE BOX/CONDUITS/DEVICES/WIRING IS REQUIRED TO BE RETAINED TO MAINTAIN BUILDING BRANCH CIRCUITS TO OTHER DEVICES THAT REMAIN.
4. RELOCATE AND EXTEND EXISTING CONDUIT AND WIRING SYSTEMS AS REQUIRED TO SUIT THE INSTALLATION OF NEW EQUIPMENT.
5. WHEN RELOCATING ELECTRICAL AND ASSOCIATED DEVICES, CARE SHALL BE TAKEN TO AVOID DAMAGE TO DEVICES BEING REMOVED AND TO THE EXISTING DEVICES WITHIN THE BUILDING.
6. NOT ALL EXISTING DEVICES THAT REQUIRE TO BE RELOCATED, REMOVED OR REPLACED MAY BE SHOWN. THE ELECTRICAL CONTRACTOR SHALL COORDINATE WITH FMO, CONSULTANT AND GENERAL CONTRACTOR TO CONFIRM ALL DEVICES FOR REMOVAL, RELOCATION OR REPLACE EXISTING WITH NEW.

CONFIRM WITH OWNER IF ANY EQUIPMENT IS REQUIRED TO STAY. ALL EQUIPMENT, WITH EXCEPTION OF EQUIPMENT REQUIRED TO SERVE NON-DEMOLISHED SPACES OR SYSTEMS, IS TO BE REMOVED.

7. CONTRACTOR SHALL LOCATE AND PROTECT ALL EXISTING DEVICES THAT REMAIN. CONTRACTOR SHALL EXTEND, REMOVE OR RELOCATE ALL ELECTRICAL DEVICES AS NOTED AND REQUIRED TO MEET THE DESIGN INTENT.
8. PROVIDE TEMPORARY EMERGENCY LIGHTING, EXIT LIGHTING, AND FIRE ALARM DEVICES IN AREA OF WORK AND CONSTRUCTION HOarding IN ACCORDANCE WITH NORTHERN HEALTH INFECTION CONTROL REQUIREMENTS FOR DURATION OF CONSTRUCTION PERIOD. COORDINATE WITH OWNERS FORCES AND ARCHITECT.

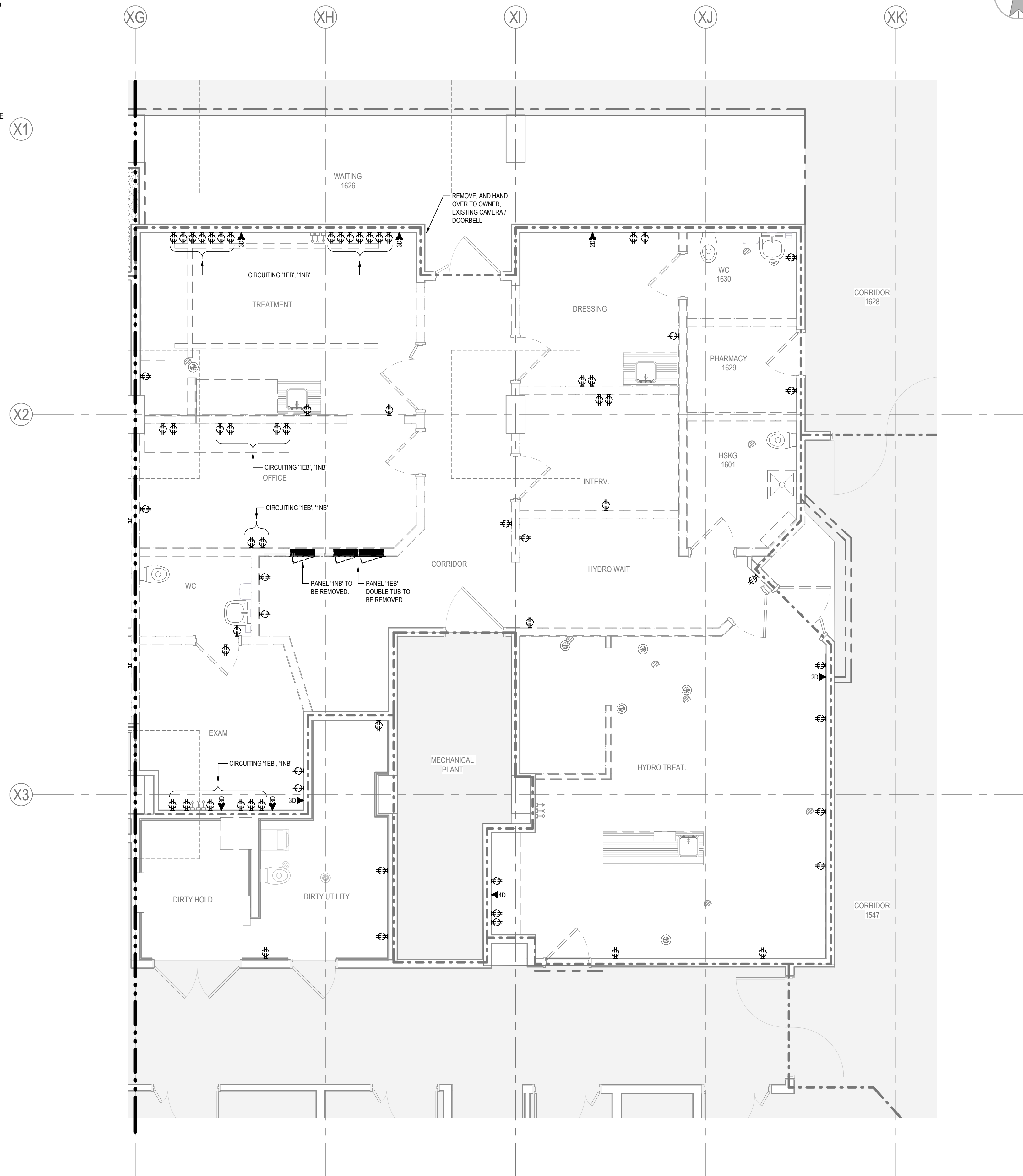

1 LEVEL 1 - DEMOLITION POWER AND COMMUNICATIONS PLAN - EAST SIDE

E200 1 : 50

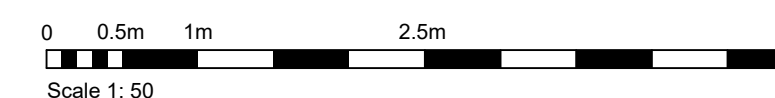

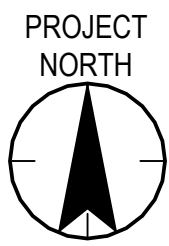

GENERAL NOTES

1. REFER TO NOTES ON DRAWING E001 AND E200.



Stantec Consulting Ltd.
1100-111 Dunsmuir Street
Vancouver, BC V6B 6A3
Tel: (604) 696-8000 • www.stantec.com

Copyright Reserved

The Contractor shall verify and be responsible for all dimensions. DO NOT scale the drawing - any errors or omissions shall be reported to Stantec without delay.
The Copyrights to all designs and drawings are the property of Stantec. Reproduction or use for any purpose other than that authorized by Stantec is forbidden.

Consultant

Notes

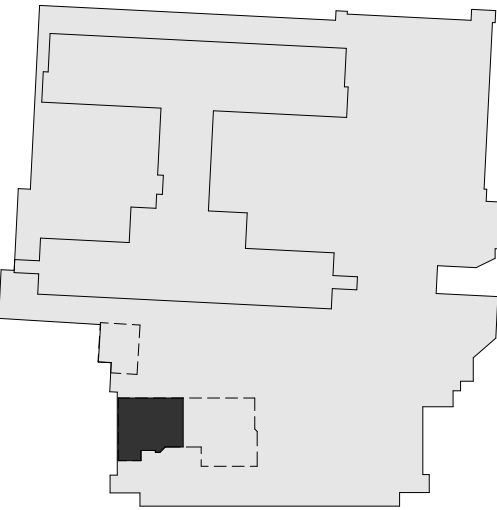

2	ISSUED FOR TENDER	CC	TF	2025.01.27
1	ISSUED FOR 100% & QS	CC	CC	2024.11.26
Issued/Revision		By	Appd	YYYY.MM.DD
File Name: N/A				
		Dwn.	Dsgn.	Chkd. YYYY.MM.DD

Permit/Seal



Client/Project Logo



Client/Project
Northern Health

UHN - Cardiac Diagnostic Services - Phase 3

1475 Edmonton St, Prince George, BC V2M 1S2

Title
LEVEL 1 - POWER & COMMUNICATIONS DEMO - WEST SIDE

Project No.
144320012

Revision
2

Scale
As indicated

Drawing No.

E201

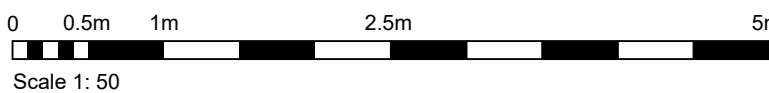

1 LEVEL 1 - DEMOLITION POWER AND COMMUNICATIONS PLAN - WEST SIDE

1:50



0 0.5m 1m 2.5m 5m
Scale 1: 50

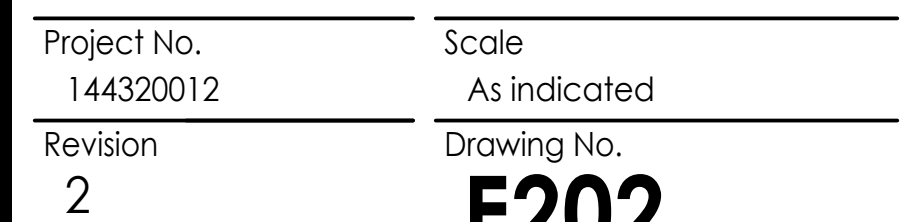



Stantec Consulting Ltd.
1100-111 Dunsmuir Street
Vancouver, BC V6B 6A3
Tel: (604) 696-8000 • www.stantec.com

Copyright Reserved

The Contractor shall verify and be responsible for all dimensions. DO NOT scale the drawing - any errors or omissions shall be reported to Stantec without delay. The Copyrights to all designs and drawings are the property of Stantec. Reproduction or use for any purpose other than that authorized by Stantec is forbidden.

Consultant

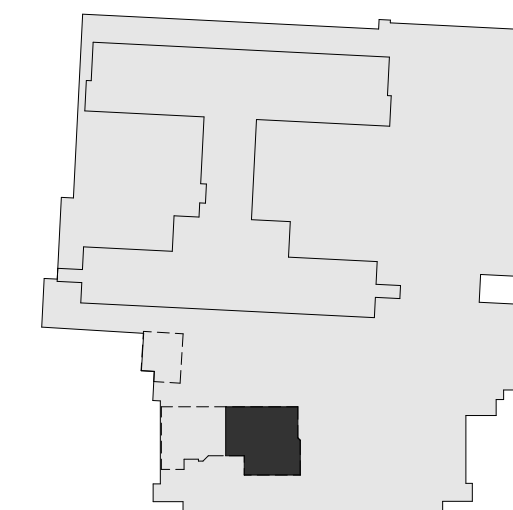
Notes[illegible]

2	ISSUED FOR TENDER	CC	TF	2025.01.2
1	ISSUED FOR 100% & QS	CC	CC	2024.11.2
Issued/Revision		By	Appd	YYYY.MM.

File Name: N/A				
	Dwn.	Dsan.	Chkd.	YYYY.MM.

Permit/Seal



Client/Project Logo

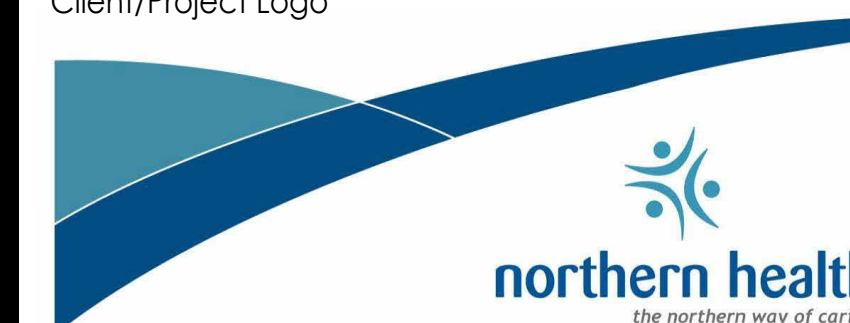

Client/Project
Northern Health

UHN - Cardiac Diagnostic Services - Phase 3

1475 Edmonton St, Prince George, BC V2M 1S2

Title
LEVEL 1 - FIRE ALARM, ACCESS
CONTROL & NURSE CALL SYSTEM
DEMO - EAST SIDE

Project No.	Scale
144320012	As indicated

Revision
2

E210

D

C

B

A

GENERAL NOTES

1. REFER TO GENERAL NOTES ON DRAWING E001.
2. NOT ALL EXISTING DEVICES THAT REQUIRE TO BE RELOCATED, REMOVED OR REPLACED MAY BE SHOWN. THE ELECTRICAL CONTRACTOR SHALL COORDINATE WITH FMO, CONSULTANT AND GENERAL CONTRACTOR TO CONFIRM ALL DEVICES FOR REMOVAL, RELOCATION OR REPLACE EXISTING WITH NEW.
3. DESIGN INTENT IS THAT ALL FIRE ALARM AND NURSE CALL DEVICES IN THE SPACE ARE TO BE REMOVED AND NEW DEVICES TO BE INSTALLED.
4. PROVIDE DUST COVERS TO PROTECT EXISTING SMOKE DETECTORS DURING HOURS OF WORK AND REMOVE AFTER HOURS FOR DURATION OF CONSTRUCTION.

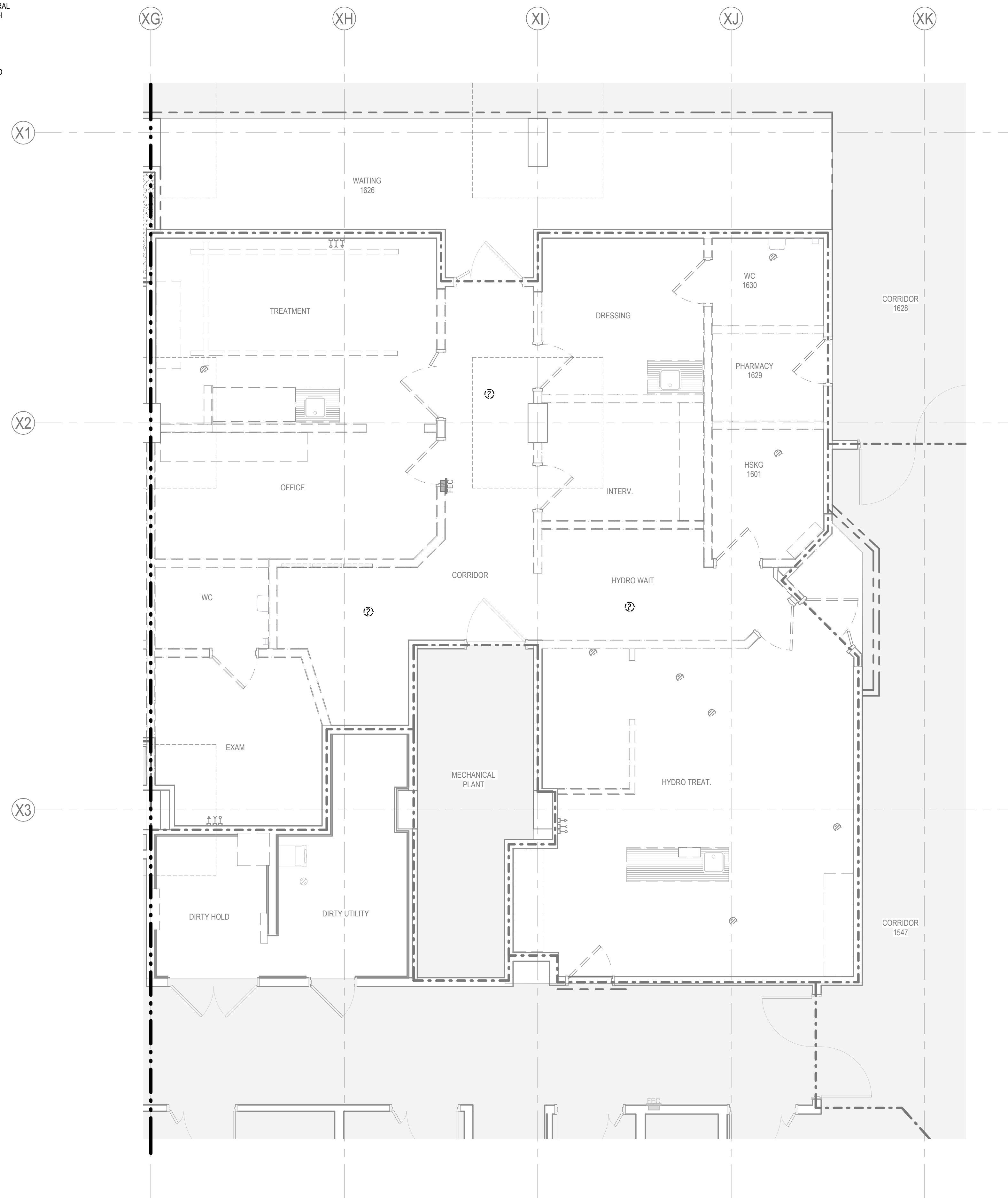

1 E210 LEVEL 1 - DEMOLITION FIRE ALARM, ACCESS CONTROL AND NURSE CALL SYSTEM PLAN - EAST SIDE 1 : 50

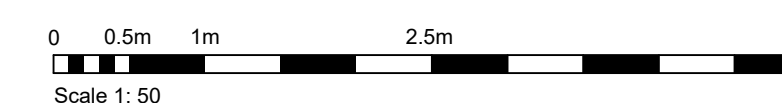



The Contractor shall verify and be responsible for all dimensions. DO NOT scale the drawing - any errors or omissions shall be reported to Stantec without delay. The Copyrights to all designs and drawings are the property of Stantec. Reproduction or use for any purpose other than that authorized by Stantec is forbidden.

Consultant

[illegible]

2	ISSUED FOR TENDER	CC	TF	2025.01.27
1	ISSUED FOR 100% & QS	CC	CC	2024.11.26
Issued/Revision		By	Appd	YYYY.MM.DD

File Name: N/A				
	Dwn.	Dsgn.	Chkd.	YYYY.MM.DD



northern health
the northern way of caring

1475 Edmonton St, Prince George, BC V2M 1S2

Project No.	Scale
144320012	As indicated

Revision
2

E211

1
E211

E211 1:50

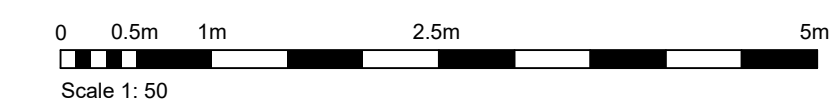

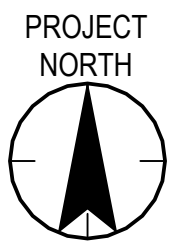

GENERAL NOTES

1. REFER TO GENERAL NOTES ON DRAWING E001.
2. REMOVE LUMINAIRES, SWITCHES, BOXES, CONDUIT, BOXES AND WIRING BACK TO SOURCE.
3. FOR ANY CONDUIT, BOXES, ETC THAT ARE SERVING EXISTING AREAS/LIGHTING TO REMAIN, THESE ARE TO BE PROTECTED/RETAINED. COORDINATE WITH SITE STAFF.



1 LEVEL 1 - DEMOLITION LIGHTING PLAN - EAST SIDE
E220 1 : 50



Stantec Consulting Ltd.
1100-111 Dunsmuir Street
Vancouver, BC V6B 6A3
Tel: (604) 696-8000 • www.stantec.com

Copyright Reserved

The Contractor shall verify and be responsible for all dimensions. DO NOT scale the drawing - any errors or omissions shall be reported to Stantec without delay.
The Copyrights to all designs and drawings are the property of Stantec. Reproduction or use for any purpose other than that authorized by Stantec is forbidden.

Consultant

Notes

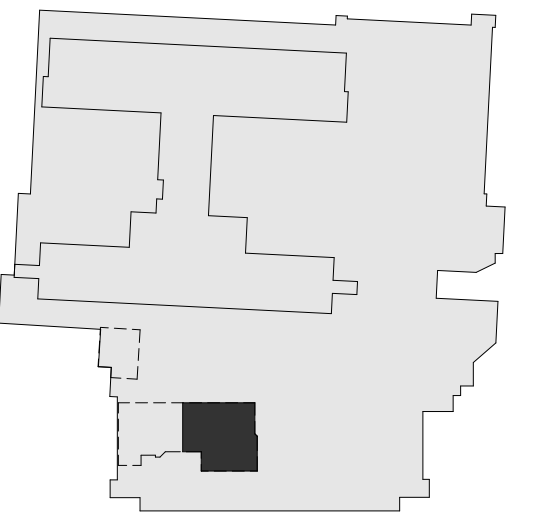

2	ISSUED FOR TENDER	CC	TF	2025.01.27
1	ISSUED FOR 100% & QS	CC	CC	2024.11.26
Issued/Revision		By	Appd	YYYY.MM.DD
File Name: N/A				
		Dwn.	Dsgn.	Chkd.
				YYYY.MM.DD

Permit/Seal



Client/Project Logo



Client/Project
Northern Health

UHN - Cardiac Diagnostic Services - Phase 3

1475 Edmonton St, Prince George, BC V2M 1S2

Title
LEVEL 1 - LIGHTING DEMO - EAST SIDE

Project No.
144320012
Revision
2
Scale
As indicated
Drawing No.
E220

File Name: N/A	_____	_____	_____	_____
	Down.	Dsgn.	Chkd.	YYYY.MM.JJ

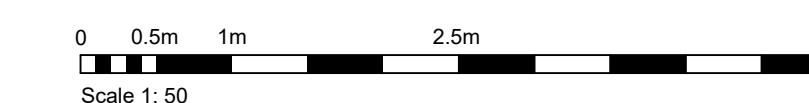

1 LEVEL 1 - DEMOLITION LIGHTING PLAN - WEST SIDE

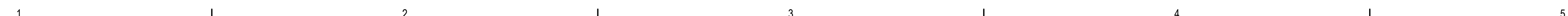

1. REFER TO NOTES ON DRAWING E001 AND E220.



The Contractor shall verify and be responsible for all dimensions. DO NOT scale the drawing - any errors or omissions shall be reported to Stantec without delay. The Copyrights to all designs and drawings are the property of Stantec. Reproduction or use for any purpose other than that authorized by Stantec is forbidden.

Notes

[illegible]

2025-01-27
Stantec Permit#: 1002862



northern health
the northern way of caring

Title
LEVEL 1 - LIGHTING DEMO - NORTH
SIDE

E222

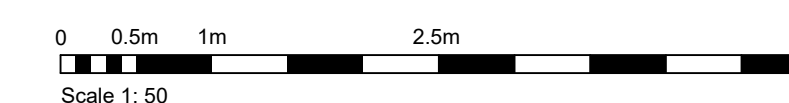

Click location in Project Information>
06-Jan-25 12:35:42 PM

ORIGINAL SHEET - ARCH D

1 E222 LEVEL 1 - DEMOLITION LIGHTING PLAN - NORTH SIDE 1 : 50



Consultant



File Name: N/A				
	Dwn.	Dsgn.	Chkd.	YYYY.MM.DD

2025-01-27
Stantec Permit#: 1002862

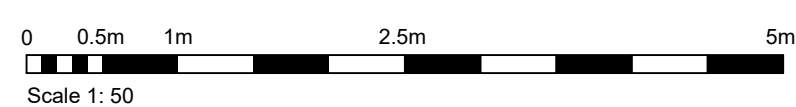

northern health
the northern way of caring

Drawing No.
E300

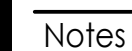

1. REFER TO NOTES ON DRAWING E001 AND E300.

[illegible]

Permit/Seal



Client/Project Logc



Client/Project
Northern Health

UHN - Cardiac Diagnostic Services - Phase 3

1475 Edmonton St, Prince George, BC V2M 1S2

Title
LEVEL 1 - POWER &
COMMUNICATIONS NEW - WEST SIDE

Project No.
144320012

Scale
As indicated

Revision
2

Drawing No.

E301

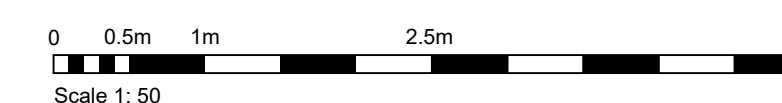

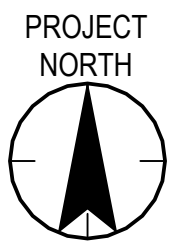

GENERAL NOTES

1. REFER TO NOTES ON DRAWING E001 AND E300.



Stantec Consulting Ltd.
1100-111 Dunsmuir Street
Vancouver, BC V6B 6A3
Tel: (604) 696-8000 • www.stantec.com

Copyright Reserved

The Contractor shall verify and be responsible for all dimensions. DO NOT scale the drawing - any errors or omissions shall be reported to Stantec without delay.
The Copyrights to all designs and drawings are the property of Stantec. Reproduction or use for any purpose other than that authorized by Stantec is forbidden.

Consultant

Notes

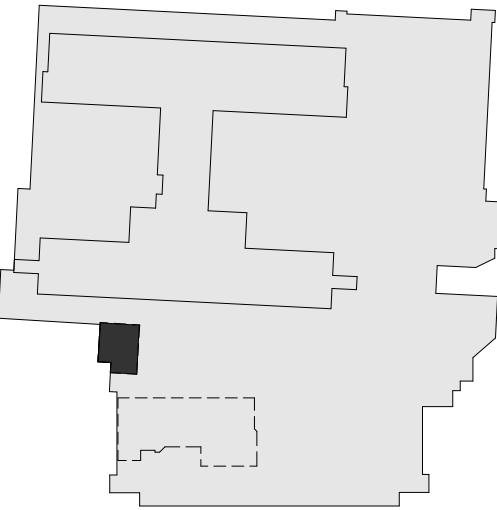

2	ISSUED FOR TENDER	CC	TF	2025.01.27
1	ISSUED FOR 100% & QS	CC	CC	2024.11.26
Issued/Revision		By	Appd	YYYY.MM.DD
File Name: N/A				
		Dwn.	Dsgn.	Chkd. YYYY.MM.DD

Permit/Seal



Client/Project Logo



Client/Project
Northern Health

UHN - Cardiac Diagnostic Services - Phase 3

1475 Edmonton St, Prince George, BC V2M 1S2

Title
LEVEL 1 - POWER &
COMMUNICATIONS NEW - NORTH
SIDE

Project No.
144320012

Revision
2

Scale
As indicated

Drawing No.

E302

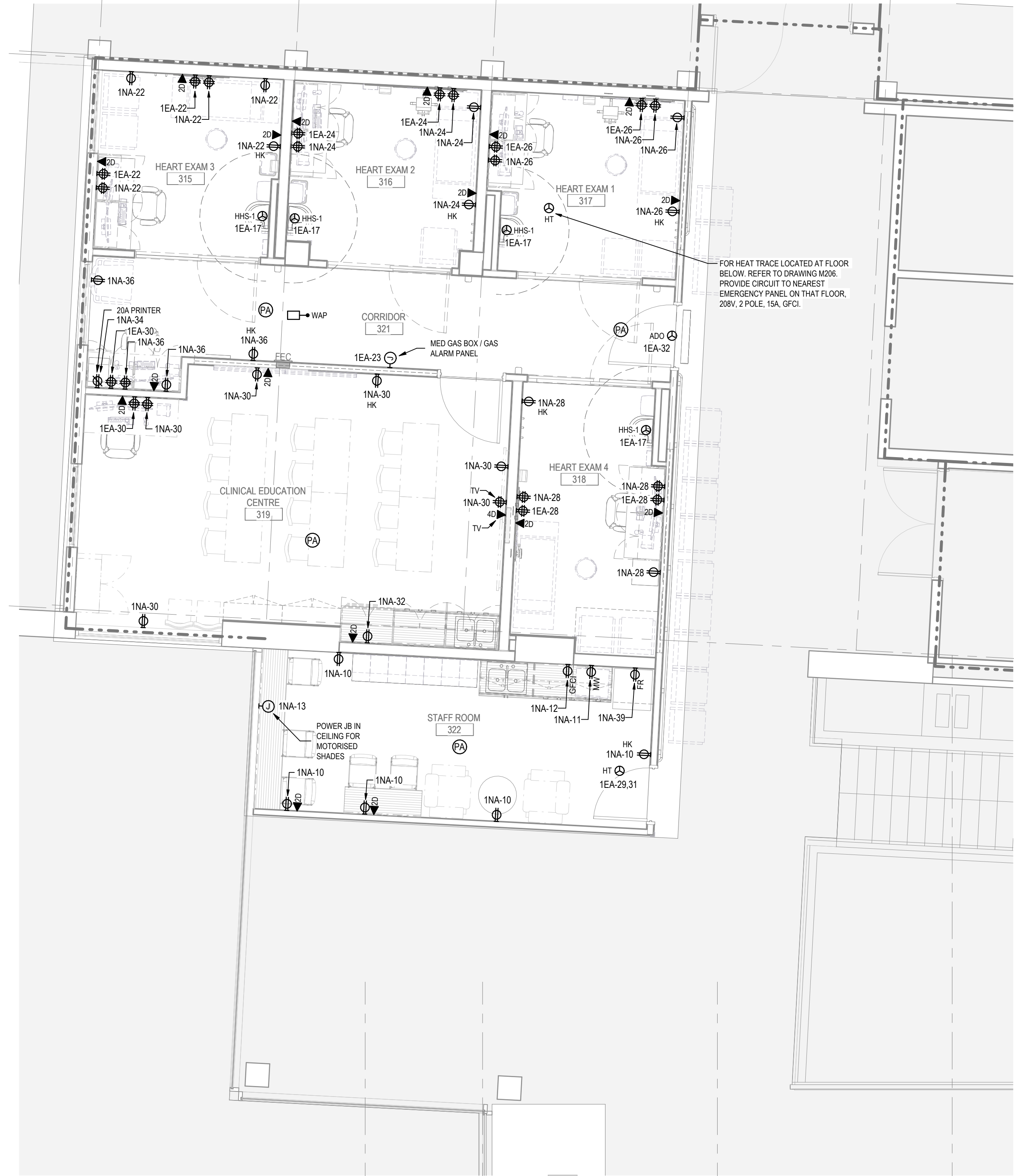

1 LEVEL 1 - NEW POWER AND COMMUNICATIONS PLAN - NORTH SIDE
E302 1:50

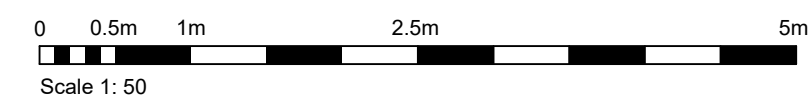

Copyright Reserved

The Contractor shall verify and be responsible for all dimensions. DO NOT scale the drawing - any errors or omissions shall be reported to Stantec without delay. The Copyrights to all designs and drawings are the property of Stantec. Reproduction or use for any purpose other than that authorized by Stantec is forbidden.

Consultant

GENERAL NOTES

1. REFER TO NOTES ON DRAWING E001 AND E310

KEYNOTES

- ➊ ADD NEW FIRE ALARM DEVICES ON EXISTING CIRCUIT WITHIN THE AREA. PROVIDE FIRE ALARM VERIFICATION.
- ➋ NURSE CALL SYSTEM TO MATCH RAULAND 5000 SERIES. COORDINATE WITH THE SUPPLIER, LOGICAL SOLUTIONS. FOR ALL SYSTEM DEVICES REQUIRED TO CONNECT TO NURSE CALL HEADEND IN MEDICAL IMAGING DEPARTMENT. NETWORK CABLEING SHALL BE IN CORRIDOR CABLE TRAY OR NEW CONDUIT. CONTRACTOR TO CONFIRM ON SITE FOR EXISTING CABLE TRAY PASS. PROVIDE 15A 120V ENDURAL. PROVIDE SUPPLY AS LOW VOLTAGE AS POSSIBLE TO EXISTING HIGH VOLTAGE PANELS. SYSTEMS TO INCLUDE STAFF EMERGENCY STATIONS, PATIENT STATIONS, DOME LIGHTS, WASHROOM/SHOWER ROOM, PULL CORD STATIONS, AND MASTER STATION CONSOLE. PROVIDE SHOP DRAWING FOR APPROVAL.
- ➌ ACCESS CONTROL DEVICES TO BE WIRED TO EXISTING KANTECH SYSTEM IN CLOSEST DATA CLOSET. LOCATE CLOSET ON SITE. COORDINATE WITH DOOR HARDWARE SUPPLIER FOR REQUIREMENT.

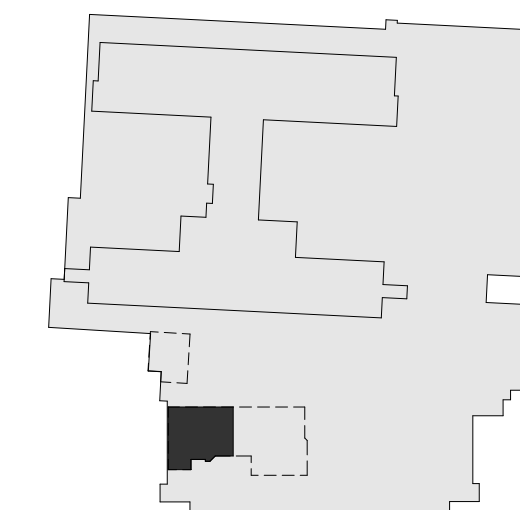
Notes[illegible]

2	ISSUED FOR TENDER	CC	TF	2025.01.2
1	ISSUED FOR 100% & QS	CC	CC	2024.11.2
Issued/Revision		By	Appd	YYYY.MM.

File Name: N/A

_____ Dwn. _____ Dsan. _____ Chkd. _____ YYYY.MM.JJ

Permit/Seal



Client/Project Logo

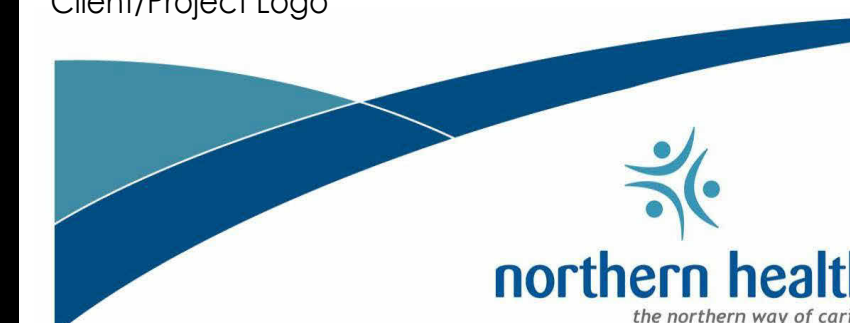

Client/Project
Northern Health

UHN - Cardiac Diagnostic Services - Phase 3

1475 Edmonton St, Prince George, BC V2M 1S2

Title
LEVEL 1 - FIRE ALARM, ACCESS
CONTROL & NURSE CALL SYSTEM
NEW - WEST SIDE

Project No.	Scale
144320012	As indicated

Revision	Drawing No.
----------	-------------

2

E31 1

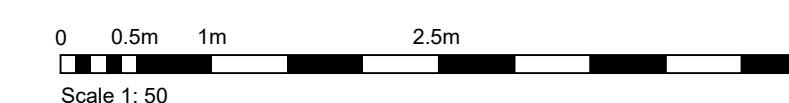



ORIGINAL SHEET - ARCH D



2. PER CSA Z32, ALL PATIENT BEDS MSUT HAVE 750 LUX DELIVERED AT BED SURFACE.

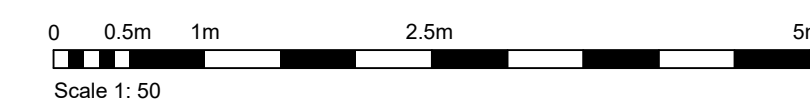

[illegible]

2025-01-27
Stanlec Permit#: 10021



northern health
the northern way of caring

Title
LEVEL 1 - LIGHTING NEW - WEST SIDE

Scale
As indicated

Drawing No.
E321

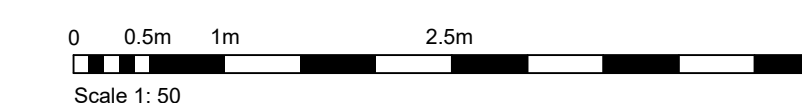



Copyright Reserved

The Contractor shall verify and be responsible for all dimensions. DO NOT scale the drawing - any errors or omissions shall be reported to Stantec without delay. The Copyrights to all designs and drawings are the property of Stantec. Reproduction or use for any purpose other than that authorized by Stantec is forbidden.

Consultant

Notes



1. THE FOLLOWING REQUIREMENTS APPLY TO THE PATENT CARE ENVIRONMENT (PCE). THE PCE CONSISTS OF THE AREA WITHIN 2m OF THE EXAM BED OR CHAIR, AND UNDER 2.3m x 4.5 F.F.
2. BONDING CONDUCTORS TO BE INSULATED, GREEN, COPPER, MINIMUM #10 OR AS INDICATED.
3. RECEPTACLE BONDING CONDUCTORS TO BE RUN IN SAME RACEWAY AS POWER CONDUCTORS.
4. PROVIDE #6 COPPER INSULATED BONDING JUMPER INSTALLED FROM NEW RIBB TO SOURCE PANEL, GROUND BUS.
5. EACH PANELBOARD SUPPLYING BRANCH CIRCUITS SHALL BE BONDED TO GROUND BY A COPPER UTILIZATION EQUIPMENT BONDING CONDUCTOR. BONDING CONDUCTOR TO BE INSTALL IN SAME RACEWAY AS CONDUCTORS SUPPLYING PANEL. (OR INCORPORATED INTO CABLE ASSEMBLY, SEE AS INDICATED)
6. PROVIDED EXISTING EQUIPMENT BONDING CONDUCTOR FOR EACH MULTI-WIRE BRANCH CIRCUITS.
7. EACH 2-WIRE BRANCH CIRCUIT SUPPLYING A RECEPTACLE IN A PATIENT CARE ENVIRONMENT SHALL BE PROVIDED WITH ITS OWN BONDING CONDUCTOR RUN TO THE ROOM REFERENCE GROUND BUS, EXCEPT WHERE:
 - WHEN RECEPTACLE IN A PATIENT CARE ENVIRONMENT ARE SUPPLIED FROM TWO, 2-WIRE BRANCH CIRCUITS IN THE SAME RACEWAY, A SINGLE BONDING CONDUCTOR MAY BE USED.
 - WHEN RECEPTABLES SERVING ADJACENT PATIENT CARE ENVIRONMENTS ARE SERVED BY THREE (3) WIRE BRANCH CIRCUITS, WITH ONE CIRCUIT SHARED BY BOTH ENVIRONMENTS, THE THREE CIRCUITS MAY SHARE 2 CONDUCTORS.
8. ALL EXPOSED, NON-CURRENT CARRYING METAL PARTS OF COMMUNICATION, RADIO, OR TV EQUIPMENT, SUCH AS TELEPHONE SETS, LOCATED IN THE PATIENT CARE ENVIRONMENT, AND WHICH MAY BECOME ENERGIZED, SHALL BE BONDED BY COPPER EQUIPMENT BONDING CONDUCTOR CONNECTED TO BONDING SCREW IN THE COMMUNICATION SECTION OF A BARRIERED AND GANGED METAL, OUTLET BOX THAT SERVES THE PCE OR TO THE ROOM REFERENCE GROUND BUS (AS INDICATED ON SCHEMATIC).
9. ALL EXPOSED, NON-CURRENT CARRYING METAL PARTS OF NON-ELECTRICAL EQUIPMENT, LOCATED IN THE PATIENT CARE ENVIRONMENT, AND WHICH MAY BECOME ENERGIZED, SHALL BE BONDED BY COPPER EQUIPMENT BONDING CONDUCTOR CONNECTED TO THE ROOM REFERENCE GROUND BUS.
10. NON-CURRENT CARRYING METAL PARTS OF NON-ELECTRICAL EQUIPMENT MAY INCLUDE, BUT IS NOT LIMITED TO:
 - METAL PARTS OF MEDICAL CASE EQUIPMENT.
 - MED GAS (OXYGEN PLUMBING AND CONNECTIONS WHERE EXPOSED).
 - METAL SINKS AND PLUMBING.
 - METAL PARTS OF CONSOLES OR SUPPORT ARMS.

1 **DE**
E401 1:1

1:1



- ➊ ALL NEW DEVICES TO MATCH EXISTING SIMPLEX 4120 FIRE ALARM SYSTEM.
- ➋ EXISTING FIRE ALARM INITIATING CIRCUIT.
- ➌ PROVIDE NEW SIGNALING DEVICES AND CONNECT TO EXISTING FIRE ALARM SYSTEM AS SHOWN. PROVIDE VERIFICATION INSPECTION REPORT FOR ALL NEW AND RELOCATED DEVICES.
- ➍ FOR FSD, PROVIDE MONITOR MODULES FOR CLOSED/OPEN LIMIT SWITCHES (AS PROVIDED) AND THEN CONTROL RELAY FOR OPERATION.

3
E401

1:1



1:1



1. EXACT SPECIFICATION AND INSTALLATION METHOD SHALL BE OBTAINED BY SEISMIC ENGINEER. THE ABOVE DETAIL IS SHOWN FOR GENERAL PURPOSE ONLY.

4
E401

$$1:1$$
[illegible]

2	ISSUED FOR TENDER	CC	TF	2025.01.2
1	ISSUED FOR 100% & QS	CC	CC	2024.11.2
Issued/Revision		By	Appd	YYYY.MM.

File Name: N/A

Dwn. Dsgn. Chkd. YYYY.MM.JJ

Permit/Seal



Client/Project Logc



Client/Project
Northern Health

UHN - Cardiac Diagnostic Services - Phase 3

1475 Edmonton St, Prince George, BC V2M 1S2

Title
ELECTRICAL SCHEDULES & DIAGRAMS
(2 OF 2)

Project No.	Scale
144320012	1 : 1

Revision _____ Drawing No. _____

E401

